

CHURN DASH

Hall County Quilters Guild

March 2024

Just a friendly reminder
-- our dues of \$50.00
will be due in March for
our 2024-2025 year.



A table runner made and quilted by Margaret Johnson.

From Our President

It's the start of our New Year for the Guild. Thank you for your confidence in me to lead you for another year. We have a lot going on this year.

Your leadership group has worked hard on updating the Policy and Procedures. Please go out to the website and familiarize yourself with them.

Also, we have a new Quilt Along starting this month! Please check out Lindsey Martin's Block of the Month below and join us. It looks like it will be a lot of fun and it could be a good way to use up some of those Fat Quarters or Layer Cakes we all have.

Happy Quilting,
Bobby Martin

Upcoming Dates

March 4 - Nick Mask

March 5 - Workshop (sign up in February/contact Margaret Johnson)

March 18 - Project Day

April 1 - Cotton Patch, Rosie Crockett

April 15 - Project Day

May 3 - Lorie Steinmeltz, Choosing Color

PROGRAMS

Our program for the March 4th meeting will be presented by Nick Mask, a children's book author and illustrator who also sews stuffed animals from his books, Waffles the Cat. He will have books and the custom fabric he uses for sale. Nick travels between the Gainesville area and Montana.

Tuesday, March 5th we will have a workshop taught by the staff of Sew Sew Studio in Bogart, "Free Motion Reverse Applique." Those who are taking the class will receive an email from me with details.

Upcoming programs: April - Rosie Crockett from Athens, trunk show

May - Loree Steinmetz, presenting a program about selecting and using color

June - picnic at Eagle Ranch

Thanks to all who have given me ideas, names and contact info for future programs...keep it up! I surely appreciate that Dean Ray and Susan Steele have volunteered to help me with programs.

Margaret Johnson

Nimble Thimbles

Nimble Thimbles is a Guild Bee that meets once a month on the Fourth Thursday to work on hand sewing projects like cross stitching, English Paper Piecing or Binding. The Bee is open to all members of the Guild. If you are interested or need more information, please contact Trisha Brisbois or Jenny Grandfield.

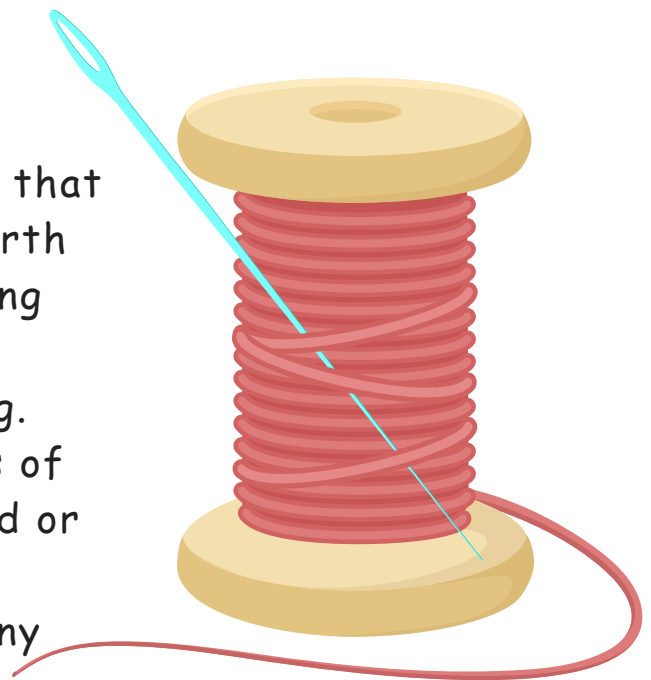

Note: If Hall County Schools close due to inclement weather, guild meetings for that day will also be cancelled.

MARCH *birthdays!*

3/1	Gail Thomas
3/2	Robin Tanis
3/3	Beth Drummond
3/8	Barbara Wyatt
3/10	Roxan Brown
3/10	Morel Ann Klatka
3/16	Kate Bathe
3/22	Laura Nagy
3/29	Teri Morgan

NEW MEMBERS

Welcome to our newest member -

Amy Brigham

Please meet Amy at our next meeting and make her feel at home.

SUNSHINE

Please remember - if you hear of a member that is sick or hasn't been to a meeting in awhile, let Carol Johnson know so that she can send a Get Well or a Thinking of You card from the Guild.

DOG AND CAT BEDS

Hello all,

Keep up the good work making dog and cat beds. The Humane Society is always appreciative when I deliver a car load.

Thanks for all you do.

Chris Anderson

NEW UPDATED BUDGET!!

Please go to the website and look at the proposed BUDGET for 2024-2025.

It will be voted on in
March!

Birthday Raffle

Please remember to bring a gift for the Birthday raffle the month of your birthday. Know that your gift may not be used that particular month, but it will be used at some later date. We appreciate all the birthday raffle items. Hope you win this month.

THANKS

EAGLE RANCH

Has anyone seen me??? I'm lost and looking to return back to the Eagle Ranch committee. Please help me get back.



PROJECT DAY

Project Day will on March 18th and will be an open sew day. You can sew any of your own projects during Project Day. We will be there from 9:30 am until 2 p.m. That's 4.5 hours of time to sew with friends! Every month!



DON'T FORGET!

Just a friendly reminder our dues of \$50.00 will be due in March for our 2024-2025 year.

Please print out and update the membership form that is found in the "Membership Information" section on the website.

If all your information has not changed -- home phone, cell, email address, home address, or emergency contact -- just write "same" next to your name and return with your dues.

Welcome to the Hall County Quilt Guild 2024 Quilt Along!

This will be a 6 month project with two 12" and two matching 6" blocks each month. The intro provides info for using a layer cake or fat quarters. You are welcome to use yardage or scraps if you choose. Below are the Introduction for this Quilt Along and Blocks One and Two. We hope you'll join us and share your unique take on this project.

Lindsey Martin

“ Sisters” Block of the Month QAL 2020

Sampler Quilt from a Layer Cake or 12-15 Fat Quarters
Designed by Abigail Dolinger, 2019

Size: 68" x 75"
Number of 12" blocks: 12
Number of 6" blocks: 12
Number of 6" squares (light fabric): 12
Sashing between blocks: 2"
Sashing between columns: 3"
Borders: 3," 3 ½"

Fabrics:

1 pkg. 10" squares, 42 total **OR** 12-15 Fat Quarters
Choose a pkg. containing mostly medium and dark fabrics.
3 yds. light background fabric
1 ½ yd. light background fabric for sashing between columns as well as 1st border
This fabric can be the same or slightly different than the 3 yds. listed above.
1 ½ yds. medium dark or dark fabric for outer border
4 ½ yds. backing fabric
¾ yds. binding fabric

Sorting the fabric:

When sorting 10" squares or fat quarters, vary the colors, scales, textures, and intensity in each grouping. For example you may select

- 1) large scale dark print,**
- 2) small scale medium print, and**
- 3) tone-on-tone texture**

If using a Layer Cake, sort the squares into 12 groups with 3 10" squares each.

Set aside the remaining 6 squares in a container labeled "FREE." Reserve the lightest squares to cut into 6 ½" plain alternate blocks.

Use each group of 3 10" square plus light background fabric to make a 12" block and a 6" block of the same (or nearly the same) patchwork design.

You may use any of the "FREE" squares in any of the blocks.

After making a 12" block and a 6" block, place the scraps in the "FREE" container.

If using Fat Quarters, sort them into 4 groups with 3 FQs each.

After making the first 4 sets of blocks (a 12" and a 6" block per set), sort the FQs again to achieve different combinations of the prints. Make the 2nd set of blocks. Then sort a final time to make the 3rd set of blocks for a grand total of 12 12" blocks and 12 6" blocks.

“Sisters” BOM- Block 1

Written by Abigail Dolinger

“Dutchman’s Puzzle” is a time honored design dating from the 1890’s. It is composed of eight “Flying Geese” units made from two contrasting fabrics plus background. We will use a “four-at-a-time,” no waste method for making the geese for the 12” block. If you are using 10” squares, cut conservatively so you can use the scraps to make the geese for the 6” block using the “one-rectangle, two-squares” method.

Select a group (of 3) fabrics to work with. Choose 2 with the most contrast in value; place the 3rd in your “FREE” box. **RST**= right sides together. **WOF**= width of fabric, selvage to selvage.

Cutting for the 12” block – from each of the 2 colored fabrics (red and yellow), cut $1\ 7\ \frac{1}{4}$ ” square. (*Impt.: See cutting diagram at the end of the instructions.*) From light background fabric, cut a strip $3\ \frac{7}{8}$ ” x WOF, then sub-cut $8\ 3\ \frac{7}{8}$ ” squares. Draw a diagonal line on the wrong side of all 8 background squares.

Sewing the 12” block – Make 8 “Flying Geese” units:

Place a $3\ \frac{7}{8}$ ” background square in opposite corners of a $7\ \frac{1}{4}$ ” colored square, RST.

The corners of the background squares will overlap in the center.

Sew $\frac{1}{4}$ ” away from both sides of the drawn line.

Cut on the drawn line and press background triangles away from the colored triangle.

Place another $3\ \frac{7}{8}$ ” background square in the 90 degree corner and sew $\frac{1}{4}$ ” away from both sides of the drawn line.

Cut on the drawn line and press background triangles

away from the colored triangle. *All 8 units should measure $3\ \frac{1}{2}$ ” x $6\ \frac{1}{2}$ ”.*

Having trouble understanding this construction method?

Tutorial - https://www.youtube.com/watch?v=_stvQx9cjEw

Observe the method ~~but use the measurements given above for 3” x 6”~~ (finished) geese.

Block Assembly – Lay out the units for the 12” “Dutchman’s Puzzle” on your table, using the photo as a guide. The boldest color will make a “Pinwheel.” Sew the units together in quadrants, and then sew the quadrants together as a “Four Patch.” *The block measures $12\ \frac{1}{2}$ ” square.* (See the diagram for Block Assembly at the end of the instructions.)

Cutting for the 6” block – from *each* of the 2 colored fabrics (red & yellow), cut $4\ 2$ ” x $3\ \frac{1}{2}$ ” rectangles.

From light background fabric, cut $16\ 2$ ” squares.

Draw a diagonal line on the wrong side of all 16 background squares.

Sewing the 6” block – Make 8 “Flying Geese” units:

place a background square on the right side

of each colored rectangle, RST. Orient the drawn diagonal line as shown.

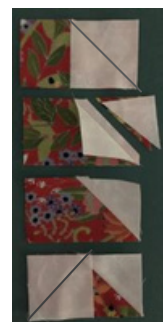

Sew on the drawn line. Press the triangle upward, matching the corners to check sewing accuracy. Then flip triangle downward and trim away excess seam allowance. Flip the triangle upward again. Now place a background square on the left side of each colored rectangle, RST. Orient the drawn diagonal line as shown. Sew, press, and trim as above. *All 8 units should measure 2" x 3 1/2."*

Do you need a visual for this method of constructing Flying Geese?

Tutorial - https://www.youtube.com/watch?v=OEW8e7_TNHk

Observe the method *but* use the measurements given above for 1 1/2" x 3" (finished) geese.

Block Assembly - Lay out the units for the 6" "Dutchman's Puzzle" on your table, using the photo as a guide. The boldest color will make a "Pinwheel." Sew the units together in quadrants, then sew the quadrants together as a "Four Patch." *The block measures 6 1/2" square.*

Block Assembly Diagram

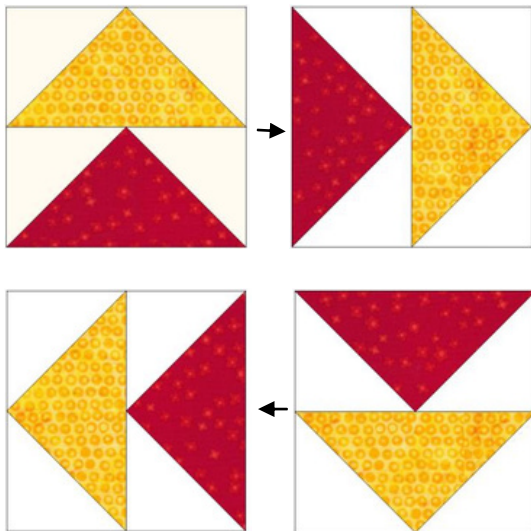

Sew the 1st quadrant to the 2nd quadrant to make the top half of the block. Press seam as indicated by the arrow.

Sew the 3rd quadrant to the 4th quadrant to make the bottom half of the block. Press seam as indicated by the arrow.

Then sew the two halves together. Press seam open or to one side.

Cutting Diagram for Colored Squares

From *each* of 2 colored squares, cut 1 7 1/4" square to make 4 "Flying Geese" for 12" block.

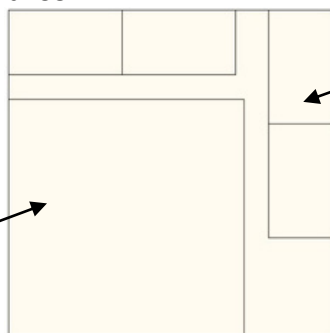

From *each* of 2 colored squares, cut 4 2" x 3 1/2" rectangles to make 4 "Flying Geese" for 6" block.

Extra Info:

History - The name "Dutchman's Puzzle" first appeared in the catalog of a mail order quilt pattern company called *Ladies Art Company* around 1895. In 1894 the pattern was published in the *Ohio Farmer* and was called "Wheel." The *Ohio Farmer* renamed the block "Dutchman's Wheel" and published it in 1898. (Barbara Brackman's *Encyclopedia of Pieced Quilt Patterns*)

“Sisters” BOM- Block 2

Written by Abigail Dolinger

“Twin Star” has eight star points, four of a dark fabric and four of a medium fabric. If you focus on the dark star points, you see a “Friendship Star” that overlays its twin spinning in the opposite direction. For a chatty tutorial detailing this block’s construction link to the following URL:

<https://www.youtube.com/watch?v=vhVa0gvFjWs>

Select a group (of 3) fabrics to work with. You might like

a large scale print for the block center, a dark for the large triangles and a medium for the small triangles. Use the leftovers from making the 12” block when constructing the 6” block. See cutting diagrams for 10” squares at the end of the instructions.



Cutting for the 12” block – From light background fabric, cut a strip 4 ½” x WOF; sub-cut 4 4 ½” squares. Also from light background fabric, cut a 5 1/2” square. From large scale print, cut one 4 ½” square for the center of the block. From dark print (black), cut 2 5” squares. Cut these diagonally in half. From medium print (lilac), cut 1 5 ½” square.

Sewing the 12” block – Make quarter square triangles by layering the 5 ½” medium print square with the 5 ½” background square, RST. Cut on both diagonals. With the background fabric uppermost, sew one short side of the triangle pairs. Be careful to feed the 90 degree angle under the presser foot first. Press the seams toward the medium print triangles.

Trim to 4 ½” square

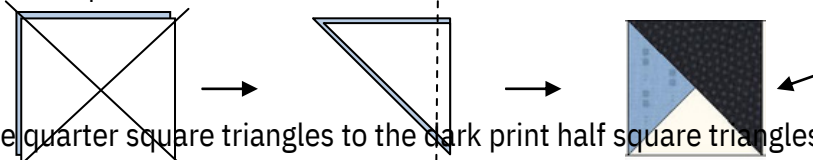

Sew the quarter square triangles to the dark print half square triangles. Press seams toward the dark print triangles. Trim these 4 units to measure 4 ½” square. (The You Tube tutorial clearly shows how to place the ruler’s 2 ¼” mark on the center seam of the block and the diagonal line of the ruler on the diagonal seam prior to trimming.)

Block Assembly - Referring to the diagram, lay out the units for “Twin Star.” Assemble the row as a “Nine Patch” of 3 rows with 3 units each. Arrows indicate pressing direction. The block measures 12 ½” square.

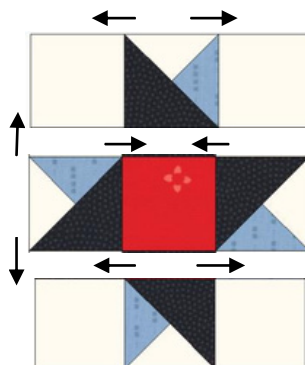

Cutting for the 6" block - From light background fabric, cut a strip 2 ½" x WOF; sub-cut 4 2 ½" squares

Also from light background fabric, cut a 3 ½" square

From dark print (black), cut one 2 ½" square for the center of the block

From large scale print, cut 2 3" squares. Cut these diagonally in half

From medium print (lilac), cut 1 3 ½" square

Sewing the 6" block – (See sewing diagrams above.) *Make quarter square triangles* by layering the 3 ½" medium print square with the 3 ½" background square, RST. Cut on both diagonals. With the background fabric uppermost, sew one short side of all four triangle pairs. Be careful to feed the 90 degree angle under the presser foot first. Press the seams toward the medium print triangle.

Sew these quarter square triangles to the large scale print triangles. Press seams toward the large scale print triangles. *Trim these 4 units to measure 2 ½" square*; place the ruler's 1 ¼" mark on the center seam of the block and the diagonal line of the ruler on the diagonal seam.

Block Assembly - Referring to the diagram, lay out the units for "Twin Star." Assemble the row as a "Nine Patch" of 3 rows with 3 units each. Arrows indicate pressing direction. *The block measures 6 ½" square.*

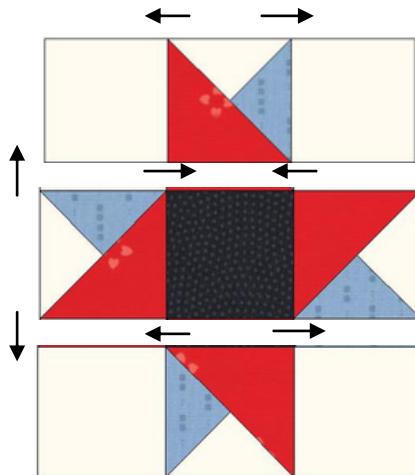

Cutting Diagrams for 10" squares – includes pieces for both 12" and 6" blocks

Dark Print Large Scale Print Medium Print

2 5" squares 1 4 ½" square 1 5 ½" square
 1 2 ½" square 2 3" squares 1 3 ½" square

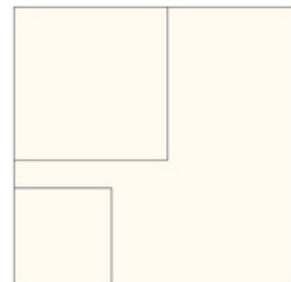
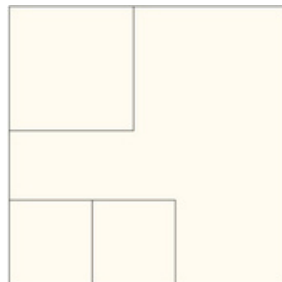
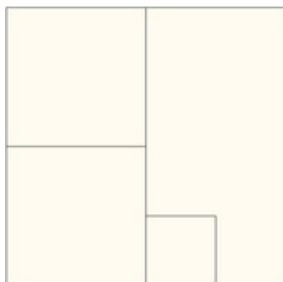

Meeting called to order at 9:50 AM

Margaret Johnson introduced Linda O'Donnell and her sisters, Sue & Penny. Linda is a former member of our guild. She and her sisters have traveled extensively and have worked together to create original art quilts inspired by their travels. Most of the quilts were made using fabrics purchased in Africa and feature colorful panels and abstract prints.

Break

Welcome by Bobby Martin

Nominating Committee Report – Sharon Weir: The current officers will be serving again for 2024-2025 and all were voted unanimously.

Minutes – Minutes for the January meeting have been posted on the guild website. Motion to approve by Chris Anderson, seconded by Peggy Johnson.

Treasurer report – The January treasurer's report has been posted to website. The proposed budget for 2024-2025 was also posted. After much discussion, approval of the budget was tabled until the March meeting. Denise Ulrich made a motion, seconded by Susan Steele, to create a committee to look into the needs of Eagle Ranch. Committee members are Susan Steele, chairman; Jenny Thomas, Peggy Johnson & Kate Bathe.

Tip of the Month: Bobby Martin showed two different tools to quickly cut the threads when you are chain-piecing.

A new guild "quilt-along" was presented by Lindsay Martin. This is a 12-block sampler and 2 blocks will be made each month.

COMMITTEE REPORTS:

Eagle Ranch – Peggy Johnson

- Kits are still available. Peggy needs 1 more Hobbs label to buy batting.

Membership – Carol Harting

- Today's attendance: 43 members, 1 new member and 2 guests

Programs – Margaret Johnson

- Nick Mast, an author and illustrator, will be the speaker at the March meeting. He will have some of his books for sale.
- March 5 is the workshop by Sew Sew Studio.
- Upcoming programs can be found on the website.

Project Day – Connie Murphy

- February will be a charity sew day; kits will be available for all charity projects.

Community Service – Connie Murphy

- Kits are available for walker bags and breast cancer pillows. She said she has so many finished items that she will be able to take them to 3 places.

Newsletter & Website – Jenny Grandfield

- Debbie Dill sent out the latest newsletter. They are trying to keep it interesting & fun!

Welcome – Trisha Brisbois

- A drawing was held for 3 rewards.

OTHER REPORTS:

Pet beds – Chris Anderson

- Today she has a car full of pet beds to go to NE Georgia Humane Society. They are always glad to get them along with gently used sheets & towels.

Quilts for Kids – Betty Wright

- They had a large turn-out for their last workshop.
- 90 quilts were taken to the hospital on Friday.
- Mark Vieira said they have more baby sheets that need the elastic cut out of if anyone is interested.

Retreat – Bobby Martin

- The retreat, 2/13-2/16, has 2 openings. An email went out to those who are attending.

Birthday Raffle – Sharon Weir – Don't forget that when it is your birthday month, you are to bring a gift for the raffle table.

Show & Tell

If you bring something for the “free” table, you must take it home if it's there at the close of the meeting.

THOUGHT FOR THE MONTH: Advice from a quilter – make lasting memories. Keep your friends in stitches. Find common threads. Know when to cut corners. It's ok to be a little scrappy.

Meeting adjourned at 12:01

Respectfully submitted,
Frances Allen
HCQG Secretary 2023-2024